

# Installation Instructions

## 安裝說明書

BRAKE MASTER CYLINDER STOPPER

剎車總泵頂桿

#Q0369

### Application 適用車型

Honda Civic '06-12 FD

For LHD models 左駕車型適用

### Components 內含配件

① Bracket 支架.....	1pcs
② Rubber 橡皮.....	1pcs
③ Bolt 螺絲 (M6x1.0x25).....	3pcs
④ Nut 螺帽 (M10x1.25-14x9.5).....	2pcs

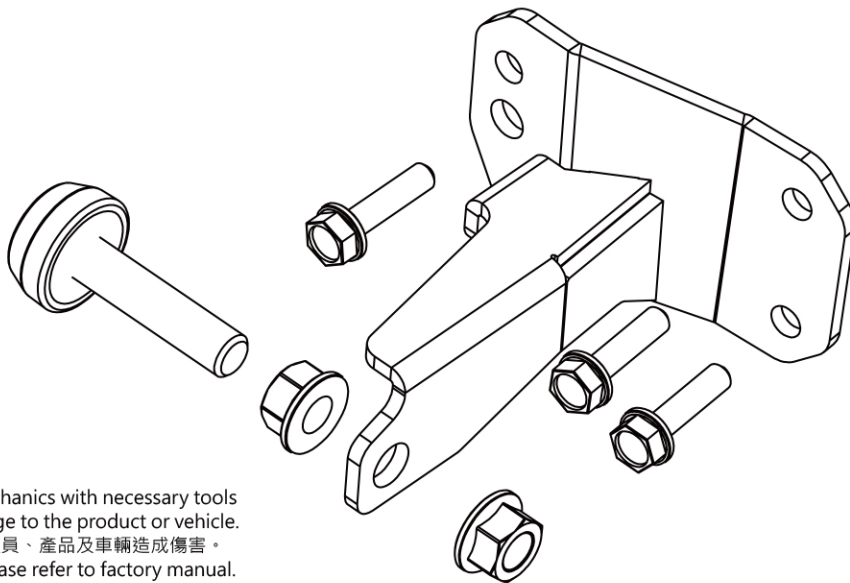

### Caution 注意事項

- Installation is recommended to be performed by licensed mechanics with necessary tools to ensure safety. Incorrect installation may cause injury, damage to the product or vehicle. 安裝建議由合格的技師及工具執行以確保安全。安裝錯誤可能對人員、產品及車輛造成傷害。
- Note the routing of wires and cables before installation, or please refer to factory manual. 安裝前請事先記下線路的安裝路徑及位置以維持原廠配置。有疑問時請參考原廠手冊。
- Tighten bolts and nuts firmly by using handtools, and with specified torque if mentioned. 安裝過程請使用手動工具確實鎖緊螺帽及螺絲。如有特別註明請依照說明指示的扭力上鎖。

### Instructions 安裝說明

1. Install supplied rubber and nuts to the bracket as shown in components figure.  
請參考配件圖。先將助頂器橡皮及螺帽安裝於頂桿支架上。
2. Remove the whole air filter box to access brake master cylinder. (See figure 1)  
將空氣濾清器拆下後找到煞車總泵。(參考圖表一)
3. Remove the two bolts securing brake fluid reservoir and the bolt securing the cable (circled). (See figure 2)  
將固定煞車油壺及線組的螺絲(畫圈處)卸下。(參考圖表二)



See figure 1 (參考圖表一)

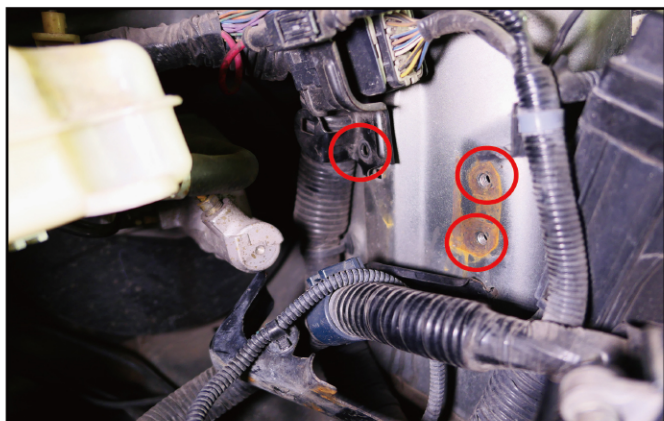

4. Install the bracket using supplied bolts.  
使用配件螺絲。安裝頂桿支架。
5. Adjust the nuts until the rubber contacts the brake master cylinder.  
調整頂桿螺帽。使橡皮支撐於剎車總泵。



Illustration of installed state  
安裝完成示意圖